

## DST450 45W Max-Type-C with PD

### Product Highlights:

- FR4 PCB
- AI workshop
- 100% ATE test
- High Reliability
- Built-in OVP, OCP and SCP
- 100% smart burn-in test for 4 Hours
- ROHS, REACH, PAHS compliant



### Safety Approvals

FTI, FCC, GS, CE, SAA, C-TICK, RCM, PSE, CCC

### Dimension

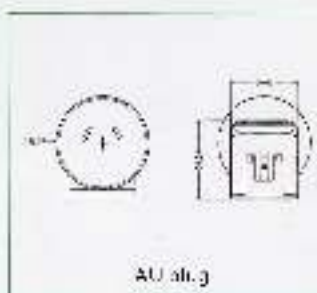
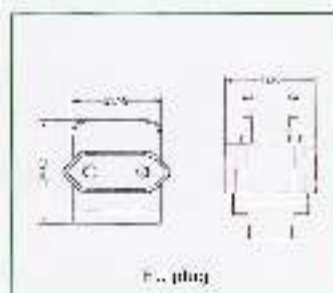

### SPECIFICATIONS

Input	Input range	100-240VAC(Full Range) 50/60Hz
	Input current(mA)	1.2A@90VAC to 85A@264VAC MAX
Output	Voltage range	DC 5-20V output
	Voltage regulation	±0.5% constant voltage mode
	Current range	5V/3A 9V/3A 12V/3A 15V/3A 20V/2.25A
	Max power(Po)	45W Max
Energy Saving	CEC, MRCAN, DOE, ERP, GEMS Efficiency Level VI	
Environmental protection	ROHS, REACH, PAHS	
Environmental	Operation temperature	0°C to +45°C ambient
	Storage temperature	-20°C to +60°C
	Operating Humidity	10%-90% (non condensing)
	Relative Humidity	5%-95% (non condensing)
	MTBF	>25,000 hours at 80% load and 25°C ambient temperature